

BL Canvas Catalogue



For more information,
Scan QR code or visit www.tangoblcanvas.com



Tango BL Canvas.





Tango BL Canvas.

Malaysia's 1st SIRIM certified 100% recycle Damp Proof Membrane (PE sheet)

Introducing our SIRIM-certified, 100% recycled damp proof membrane (PE sheets), designed to meet the highest standards of sustainability and durability.

Check out more via:
<https://tangoblcanvas.com/>

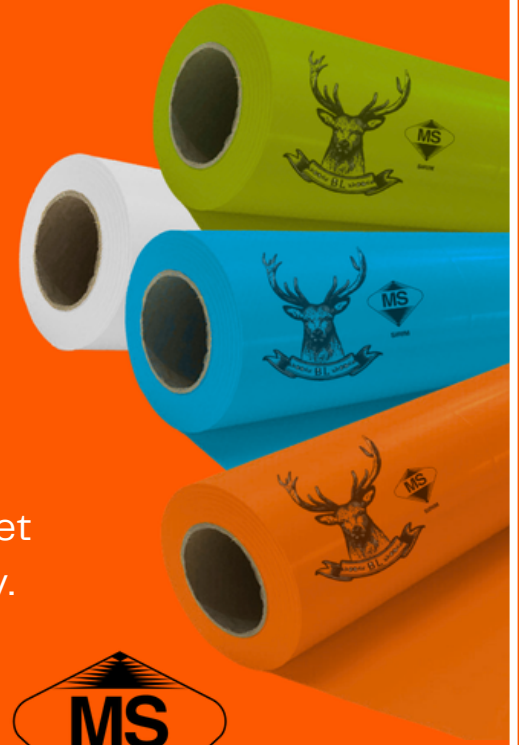

OUR PRODUCTS



BL Blue Canvas

Thickness: 0.12mm
SIRIM Verified

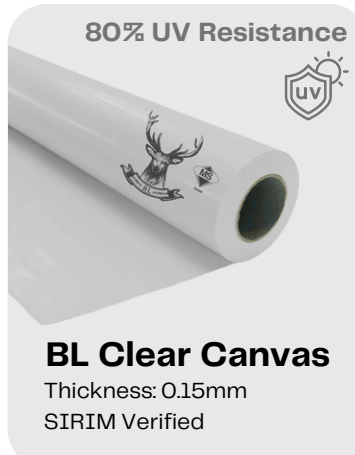

BL Clear Canvas

Thickness: 0.15mm
SIRIM Verified



BL Orange Canvas

Thickness: 0.20mm
SIRIM Verified



BL Green Canvas

Thickness: 0.25mm
SIRIM Verified

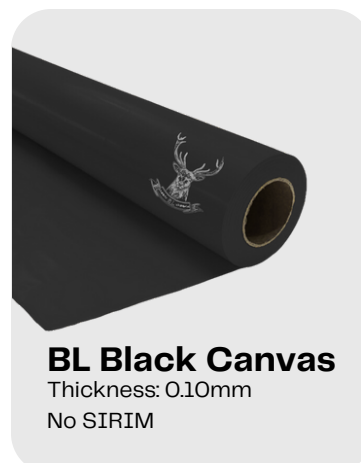

BL Black Canvas

Thickness: 0.10mm
No SIRIM

Our Products

We categorize our product portfolio into few sectors, each designed to meet the distinct requirements of various industries:

Construction Sector:

Within this sector, we offer products such as Damp Proof Membrane and Damp Proof Course. These products are engineered to deliver strength, durability, and dependable protection in diverse construction applications.

Agriculture Sector:

In the realm of agriculture, we provide specialized items like Tango Clear Canvas and Tango Black canvas. These films are tailored to create ideal growing environments by offering features such as light transmission, heat retention, and plant protection.

Custom Solutions:

We also excel at tailoring our plastic sheets to meet unique needs across different industries. These sheets can be customized to specific applications, showcasing our commitment to versatility and adaptability to cater to our customers' requirements.

SIRIM Certified

SIRIM QAS International Sdn. Bhd.
(Company No. 198012791 (43334-K))
No. 1, Persiaran Dam Dam, 70000 Seremban, Negeri Sembilan, Malaysia
Tel: 05-65440000 Fax: 05-65440001
www.sirim-qas.com.my

TEST REPORT
PAGE 1 OF 4

REPORT NO: 2022CE2673

This Test Report refers only to samples submitted by the applicant to SIRIM QAS International Sdn. Bhd. and tested by SIRIM QAS International Sdn. Bhd. This Test Report shall not be reproduced, copied or in any way used for any purpose by any person or entity without the prior written consent of SIRIM QAS International Sdn. Bhd. Please refer to the last page of this Test Report for Conditions Relating to the use of this Report.

THIS TEST REPORT IS ISSUED IN SECURED PDF SOFTCOPY

Applicant: : BANLI HARDWARE SDN BHD
14 & 16, Jalan Kilang 2
Jelapang Light Industrial Estate
30100 Ipoh
Perak

Manufacturer: : -same as above-

Product: : LDPE GREEN CANVAS (250um)

Reference Standard / Method of Test: : 1. AS 2870:2011 - Residential Slabs and Footings
2. AS/NZS 4347.6:1995 - Damp-Proof Courses and Flashings - Methods of Test - Method 6: Determining Impact Resistance (Falling Dart Impact)

Description of sample: : Test sample indicated above, green in colour, was received on 1 November 2022. Please refer to Appendix A for the photograph of the sample.

Date Received of Complete Application: : 03 November 2022

Job No.: : J022267329

Description of Test Results: : This test report covers only test clause as requested by Applicant to SIRIM QAS International Sdn. Bhd. The test result for the submitted test sample as described in this test report complied with the requirement of the above reference standard at the respective clause tested.

Issued Date: : 04 November 2022

Approved Signatory: :

(NAZARIAH BINTI MODMAN)
Testing Engineer

(HAFNAS BINTI MAHBUT)
Head
Chemical, Polymer and Composite Section
Testing Services Department

SIRIM QAS International Sdn. Bhd.
(Company No. 198012791 (43334-K))
No. 1, Persiaran Dam Dam, 70000 Seremban, Negeri Sembilan, Malaysia
Tel: 05-65440000 Fax: 05-65440001
www.sirim-qas.com.my

TEST REPORT
PAGE 1 OF 4

REPORT NO: 2022CE0655

This Test Report refers only to samples submitted by the applicant to SIRIM QAS International Sdn. Bhd. and tested by SIRIM QAS International Sdn. Bhd. This Test Report shall not be reproduced, copied or in any way used for any purpose by any person or entity without the prior written consent of SIRIM QAS International Sdn. Bhd. Please refer to the last page of this Test Report for Conditions Relating to the use of this Report.

THIS TEST REPORT IS ISSUED IN SECURED PDF SOFTCOPY

Applicant: : BANLI HARDWARE SDN BHD
14 & 16, Jalan Kilang 2
Jelapang Light Industrial Estate
30100 Ipoh
Perak

Manufacturer: : -same as above-

Product: : LDPE ORANGE CANVAS

Reference Standard / Method of Test: : 1. AS 2870:2011 - Residential Slabs and Footings
2. AS/NZS 4347.6:1995 - Damp-Proof Courses and Flashings - Methods of Test - Method 6: Determining Impact Resistance (Falling Dart Impact)

Description of sample: : Test sample indicated above, was received on 14 March 2022. Photograph of test sample is shown in Appendix A.

Date Received of Complete Application: : 15 March 2022

Job No.: : J0222670470

Description of Test Results: : This test report covers only test clause as requested by Applicant to SIRIM QAS International Sdn. Bhd. The test result for the submitted test sample as described in this test report complied with the requirement of the reference standard at the respective clause tested.

Issued Date: : 17 March 2022

Approved Signatory: :

(NAZARIAH BINTI MODMAN)
Testing Executive

(HAFNAS BINTI MAHBUT)
Head
Chemical, Polymer and Composite Section
Testing Services Department

Tango BL Canvas

(Damp Proof Membrane)

Engineered to:

- Bind resistant
- Press resistant
- Waterproof
- Sun-resistant
- Anti-aging
- Tear proof

Making them a reliable choice for even the most demanding conditions.

Key Applications:

- **Concrete Slab Underlay** – Damp proof membrane or vapor barrier (protect structures from moisture damage)
- **Landscaping** – Pond and Dam Linings
- **Roofing** – Roof protection sheets (safeguard against environmental elements)



Canvas Material

Our Polyethylene Sheets (PE) are expertly manufactured using **high-quality recycled resins** or **virgin low-density polyethylene resins**, ensuring exceptional performance across a wide range of applications.

Known for their very low biodegradability, these sheets are ideal for use as **damp proof membranes** or vapor barriers, providing long-lasting protection in various environments.



Tango BL Canvas

(Damp Proof Membrane)

Tango Black canvas (No Sirim)

50meter x 1metre (H:2metre) x 0.1mm



Tango Blue canvas (Sirim)

150ft x 12ft (H:6ft) x 0.12mm

150ft x 12ft (H:3ft) x 0.12mm

50ft x 12ft (H:3ft) x 0.12mm



Tango Clear canvas (Sirim)

100ft x 12ft (H:6ft) x 0.15mm

100ft x 12ft (H:3ft) x 0.15mm

(ANTI UV 80%)



Tango Orange canvas (Sirim)

50meter x 12ft (H:6ft) x 0.2mm

50meter x 12ft (H:3ft) x 0.2mm



Tango Green canvas (Sirim)

40meter x 4metre (H:2metre) x 0.25mm

Damp Proof Course Description



Damp proof course (DPC) waterproof material is a physical barrier inserted into the fabric of a building to stop water passing from one place to another.

Embossed damp proof course can be on a horizontal plane, stopping water rising up from the ground by being sucked up by the dry masonry, to the inside.

DPC have take many forms through the ages and one of the earliest form was to use a layer of slate in the construction. Slate is still used but the less expensive plastic version (below right) is now more widely used.

Supply

Sorts	Code	Thickness (mm)	Width(mm)	Length(m)
DPC	Embossed	0.5	110/150	30

***Packing: 150mm x 30m (4.5 m² / roll)**

8The thickness, width, length can be made based on customers' requirements.

- The DPC can be used in both vertical and horizontal applications to restrict upward and horizontal moving water within structure walls.
- DPC is unsuitable for use in applications that place high shear stress on the DPC, such as restraining walls or high flexible stress, such as freestanding walls and parapets.
- The DPC should not be used to restrict the flow of downward moving water, such as above lintels or within cavity walls.
- Suitable for use all year round, this DPC is a highly versatile product and is subject to stringent quality controls to meet all British Standards.



Advantages

- Embossed to assist mortar adhesion.
- Durable with proven performance over many years.
- Manufactured from the highest quality reprocessed material.
- Remains flexible - even at low temperatures.
- Safe and clean to handle.
- Suitable for use in horizontal and vertical applications throughout domestic construction.



Installation

Installation should be according to the code of practice CP102:1973 and normal DPC good practice procedures set in BS 5628 should be followed.

Some brief guidelines on how to use the DPC are supplied below:

-For external walls the DPC should be applied 150mm above the adjoining surface and should be linked with the PDM in solid floors. the DPC should be applied to a fresh bed of mortar, completely free of projections that may puncture the material or impede the DPC from lying flat. When joining two pieces of DPC they should be lapped over each other by at least 100mm.

-For internal walls, DPC should be installed at the base of load bearing walls and linked with any adjoining DPM. The DPC should be at least the width the partition it is applied to and lapped by at least 100mm when two DPC's are joined.

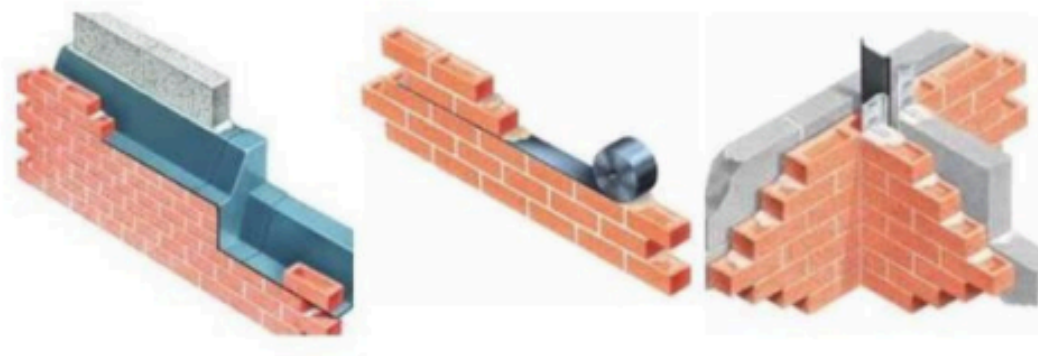

GEOTEXTILE LANDSCAPE FABRIC CONTROL MAT WOVEN GROUND COVER MEMBRANE



SIZE:
2 METER X 150 METER
4 METER X 150 METER

APPLICATION

1. Filtration of soils in drainage applications by retaining soil particles while allowing for the free flow of water
2. Separation and reinforcement in road and railway construction
3. Prevention of soil movement in erosion control measures
4. Cushioning and protection in many containment projects

DESCRIPTION

Woven geotextile is composed of at least two parallel yarns (or flat yarns). One group is called warp yarn along the longitudinal direction of the loom (the direction in which the fabric travels), and the other group is arranged horizontally, called weft yarn. The warp and weft are woven into cloth using different weaving equipment and processes, which can create varying thicknesses and densities to suit different applications.

Generally, woven geotextiles have relatively strong resistance in both vertical and horizontal directions. The tensile strength (in the latitude direction) is greater than that in the longitude direction, and they exhibit good stability performance.

Usage

Construction sites

Agricultural & Farming

Fishery & Keeping Animals

Industrial



Construction sites

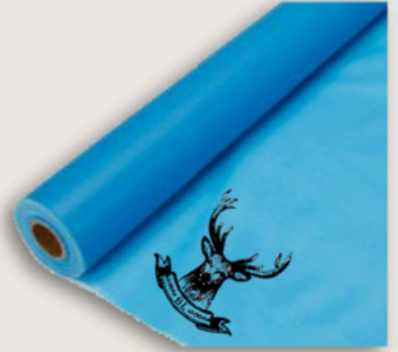

Our films (builder films) used at construction sites are normally categorized to IR2 (medium impact) and IR3 (high impact) resistance and it meets all regulatory requirements of Australia Standard AS 2870-1996, AS4347.6 and AS1326.

Agricultural & Farming



Fishery & Keeping Animals

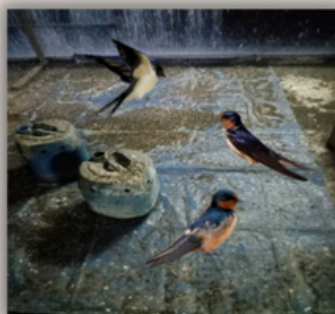

Industrial





Tango

Tango BL Canvas.

Your Best Hardware Partner

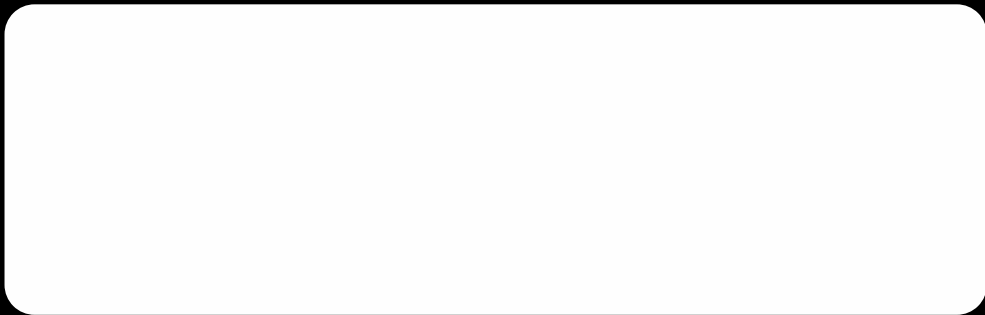

For more information,
Scan QR code or visit www.tangoblcanvas.com